

## New **CODIX**531/532



- Temperature indicator **CODIX**531 for Pt100 and Ni100 resistance thermometers
- Temperature indicator **CODIX**532 for J, K and N thermoelement sensors



mA

°C

bar

**Temperature Indicator CODIX531/532**



- Display range -19 999 ... 99 999
- Temperature display in °C or °F
- Min. / Max. storage
- Supply voltage 10 ... 30 V DC galvanically insulated with reverse polarity protection
- IP65
- Screw terminal, 5 mm grid
- Easy programming and operation
- Modern CODIX Design
- 5 measurements per second
- Display latch input
- Input range:  
**CODIX531:** Pt100, Ni100 for 2, 3 or 4-wire connection technique  
**CODIX532:** J, K, N thermoelements with external or internal cold junction compensation

**Technical features for both CODIX531/532:**

Supply voltage:	10 ... 30 V DC, galvanically insulated with reverse polarity protection	Housing:	Dimension 48 x 24 mm according to DIN 43 700; RAL 7021, grey
Current consumption:	max. 40 mA	Operating temperature:	-20 ... +65 °C
Display:	5-digit display, red 7-segment LEDs, figure height 8 mm	EMC:	according to EC EMC directive 89/36/EWG
<b>Measuring rate:</b>	5 measurements / second	Interference emission:	EN 50081-2/EN 55011 Class B
Display refresh	1 ... 2 times per second	Interference resistance:	EN 6100-6-2
Data backup:	EEPROM	Protection level:	IP65 (on the front side)
		Weight:	approximately 50 g

**Technical features CODIX531:**

Input:	Pt100 resistance thermometer Ni100 resistance thermometer with probe breakage monitoring
Supply current:	1 mA
Circuit type:	2-wire, 3-wire and 4-wire connection technique, programmable
Supply line:	2-wire: max 20 Ω, programmable 3-wire, 4-wire: max 20 Ω, no alignment required
Temperature ranges:	Pt100 acc. to DIN IEC 751: -199.9 °C ... +850.0 °C -327.8 °F ... +1562.0 °F Ni100 acc. to DIN 43760: -60.0 °C ... +230.0 °C -76.0 °F ... +446.0 °F
Resolution:	0.1 °C (0.1 °F) or 1 °C (1°F)
Linearity error:	Pt100 < 0.1 % for the whole measuring range at an ambient temperature of 20 °C Ni100 < 0.2 % for the whole measuring range at an ambient temperature of 20 °C
Temperature drift:	0.1 K/K <sub>ambient</sub>

**Technical features CODIX532:**

Input:	Thermoelement sensor J (Fe-CuNi) K (Ni-CrNi) N (NiCrSi-NiSi) with probe breakage monitoring
Temperature ranges:	Acc. to DIN IEC 584 J (Fe-CuNi) -210.0 °C ... +1200.0 °C -346.0 °F ... +2192.0 °F K (Ni-CrNi) -270.0 °C ... +1372.0 °C -454.0 °F ... +2501.6 °F N (NiCrSi-NiSi) -270.0 °C ... +1300.0 °C -454.0 °F ... +2370.0 °F
Resolution:	0.1 °C (0.1 °F) or 1 °C (1°F)
Linearity error:	< 0.4 % for the whole measuring range at an ambient temperature of 20 °C.
Cold junctions error:	+/-1.0 °C typ. +/-3.0 °C
Temperature drift	0.1 K/K <sub>ambient</sub>

**Dimensions:**

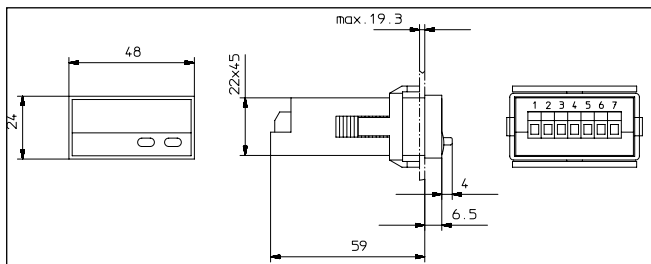

Panel cut out:  
22,2<sup>+0,3</sup> x 45<sup>+0,6</sup> mm

**Order code and scope of delivery:**

**Codix** 531: Order-No.: 6.531.012.300  
**Codix** 532: Order-No.: 6.532.012.300

**Scope of delivery:**

- Temperature indicator
- Panel mounting clip
- Bezel for screw mounting, panel cut out 50 x 25 mm
- Bezel for clip mounting, panel cut out 50 x 25 mm
- Seal
- 1 set of self-adhesive symbols
- Multilingual operating instructions