

# Technical Information

## Hour meter for DIN rail mounting Type series SH16



R.100.150

### General description:

- 6 digit hour meter for DIN rail mounting with snap-in mechanism
- 36 mm wide
- Drive:
  - Synchronous motor at AC
  - Stepping motor at DC
- Frequency standard:
  - 50 Hz at AC
  - Quartz at DC

### Applications:

Switch cabinets, distribution panels etc.

### Technical data:

Electrical connection:	Screw terminal
Number of digits:	6
Colour of figures:	white on black, decimals black on white
Size of figures:	appr. 1.5 x 3.5 mm
Power consumption:	2.5 VA at AC 1 W at DC
Supply voltage:	230 VAC $\pm 10\%$ 10-27 VDC
Ambient temperature:	-10..+70 °C at AC -10..+50 °C at DC
Colour of housing:	light grey
Weight:	appr. 60 g

- Subject to change without prior notice -

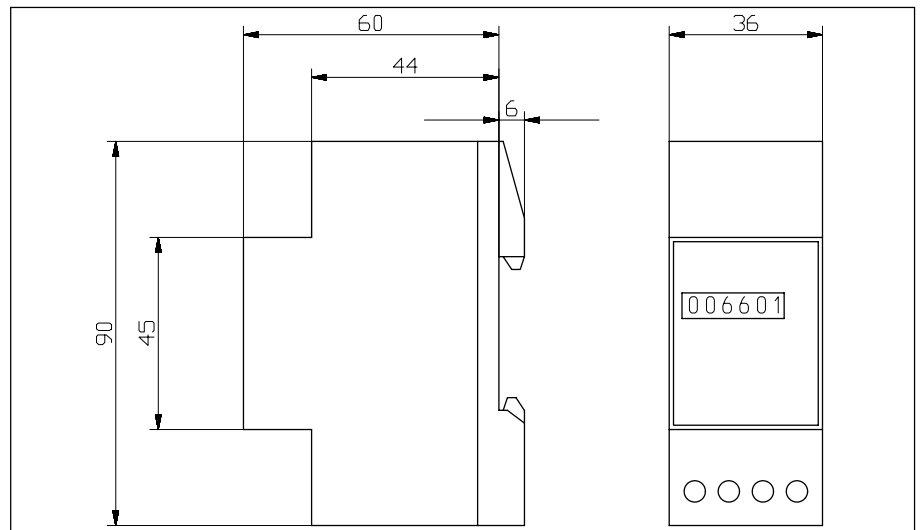

	AC (50 Hz) Art.-No	DC Art.-No
10..27 VDC		0.140.000.351
230 VAC	0.140.000.075	