

Specifications

Operating temperature range:	-40 to +60C
Storage temperature range:	-50C to +85C
Mechanical shock:	Meets SAE J1378 March 83. Amplitude 44 -55g, half sine, 9-13 ms duration.
Vibration:	Meets SAE J1378 March 83. Double amplitude of 1.53mm with frequency sweep from 10-80-10 Hz (20g max) at 1 minute intervals.
Humidity:	95% RH (non-condensing) at +38C as per SAE J1455, section 4.2.3
Sealing:	Face, IP65.
Connector:	Molex Mini-Fit Jr. (8 pin and 12 pin)
Operation voltages:	For 12V nominal: 9 to 15V, For 24V nominal: 18 to 30V
Case:	PC plastic.
Lens:	PMMA plastic.

Model Encodement

2510T	12	- 0001	OO
Model	Voltage	Sequential number (identifies panel features)	Artwork code

Note: Model 2510 =LED gages and/or a 5mm hour meter display and up to 5 indicator LEDs
 Model 2511 =LCD gages and/or a 7mm hour meter display and up to 5 indicator LEDs

Dimensions: mm

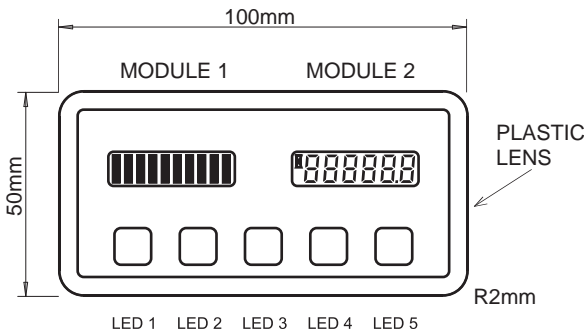

ARTWORK according to CUSTOMER REQUIREMENTS

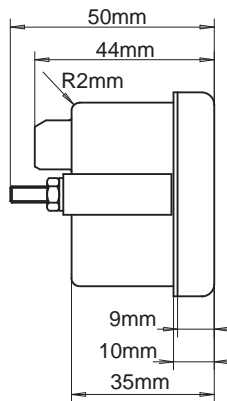
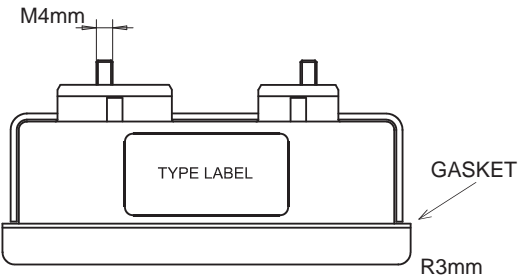

(Model 2511 shown)

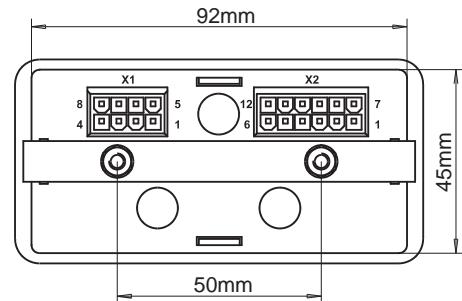

FRONT-CUT-OUT: 45+0.6 mm x 92+0.8 mm DIN 43700
 FRONT: IP 65 IEC 529

MATING CONNECTOR:

MOLEX / Housing, Dual Row, 8 / No. 39-01-2080	1 pc.
MOLEX / Housing, Dual Row, 12 / No. 39-01-2120	1 pc.
MOLEX / Female Terminal / No. 39-00-0039	18 pcs.

TYPICAL WIRING

TERMINAL	DESIGNATION	TERMINAL	DESIGNATION
X1/1	SENDER or HOURS - RESET for MODULE 1	X2/1	+ DC for LED 1
X1/2	LOWER OUTPUT or HOURS - INPUT for MODULE 1	X2/2	GROUND for LED 1
X1/3	HIGHER OUTPUT for MODULE 1	X2/3	+ DC for LED 2
X1/4	SENDER or HOURS - RESET for MODULE 2	X2/4	GROUND for LED 2
X1/5	LOWER OUTPUT or HOURS - INPUT for MODULE 2	X2/5	+ DC for LED 3
X1/6	HIGHER OUTPUT for MODULE 2	X2/6	GROUND for LED 3
X1/7	BATTERY +	X2/7	+ DC for LED 4
X1/8	GROUND	X2/8	GROUND for LED 4
		X2/9	+ DC for LED 5
		X2/10	GROUND for LED 5
		X2/11	n.c.
		X2/12	n.c.

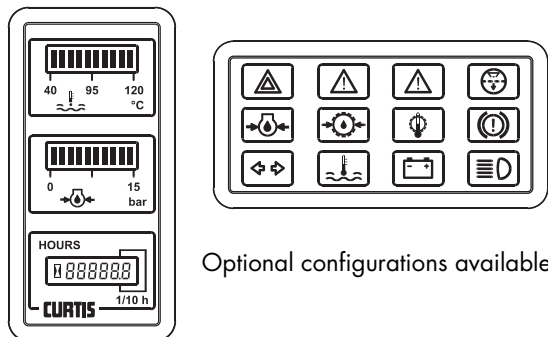

Optional configurations available