

NOTES:

1. MATING CONNECTOR: USE DELPHI PACKARD P/N 15336035
2. WEIGHT: 30 GRAMS MAX.
3. CASE MATERIAL: ABS BLACK
4. LENS MATERIAL: ACRYLIC CLEAR
5. MOUNTING HARDWARE TORQUE: 1.13-1.36 N.m.
6. OPERATING VOLTAGE: 12VDC NOMINAL, 9-15VDC ABSOLUTE
7. UNIT DESIGNED FOR A MOUNTING PANEL THICKNESS OF .8 mm - 6.4 mm.
8. RECOMMENDED PANEL CUTOUT SIZE 36.8mm X 24.1mm ±.25mm
9. MAY BE USED WITH MOUNTING BRACKET: CURTIS P/N 17607800 CONTAINS 100 BRACKETS.
10. ENVIRONMENTAL PROTECTION: FRONT IP-65, REAR IP-65 (WITH CONNECTOR INSTALLED).

Add Label to this Area:  
 AM129888  
 Line 2: Date Code and Manufacturing Location per BOM  
 Made In China  
 Pat. 4712195

PIN #	Function
1	Positive
2	Negative
3	Low Fuel - Ground to Illuminate
4	No Connection

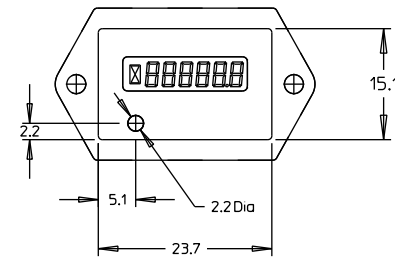
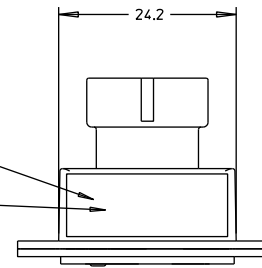
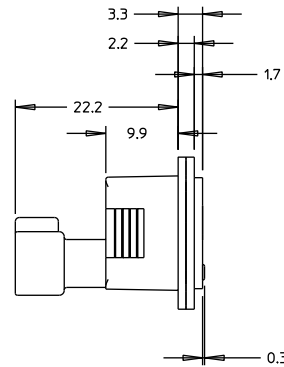
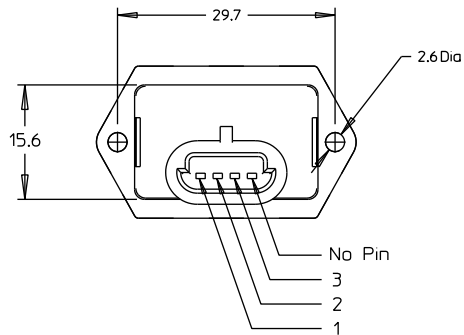

NOTICE  
 THE REVISION LEVEL OF  
 THIS DOCUMENT MUST  
 BE VERIFIED FOR LATEST  
 ISSUE BEFORE USE.

THIS DRAWING CONSTITUTES THE CONFIDENTIAL INFORMATION OF CURTIS INSTRUMENTS INC. AND ITS RECEIPT OR POSSESSION DOES NOT CONFER ANY RIGHT IN OR LICENSE TO USE IT OR THE INFORMATION DISCLOSED HERE IN NOR ANY RIGHT TO REPRODUCE THIS DRAWING OR ANY PART HEREOF WITHOUT THE WRITTEN CONSENT OF CURTIS INSTRUMENTS INC.	REVISIONS						FOR REFERENCE ONLY		UNLESS OTHERWISE SPECIFIED DIMENSIONS ARE IN mm	APPROVALS			DATE			
	SYM.	ECN	DESCRIPTION	DATE	APPR	RELATED DRAWINGS		MFG.		AK	3/22/01					
								ENGR.		AR	3/22/01					
	1	----	CREATED DRAWING	RM	---	---			ENGR.	VAI	3/22/01		Outline and Installation 732KN0001XXR			
	2	----	Moved LED	RM	---	---			CHECKED							
	3	----	Pin 4 was 'NOT USED'	RM	---	---			DRAWN	RM	9-6-00					
	4	----	Scale was 1.5:1, Updated Drawing	RM	3/22/01	VAI			MKT	CH	3/22/01					
	A	9394	RELEASE TO PRODUCTION	RM	3/23/01	VAI			DO NOT SCALE : USE DIMENSIONS							
	B	9426	REVISED NOTE 6 AND MODEL NO. 732KN0001XXR WAS 732KN01NG1248D2060A	DR					SCALE 1:1							
													CODE IDENT. NO. 18583	B SIZE	17615001 SHEET 1 OF 1	B REV